

REVISIONS		
NO.	DESCRIPTION	DATE

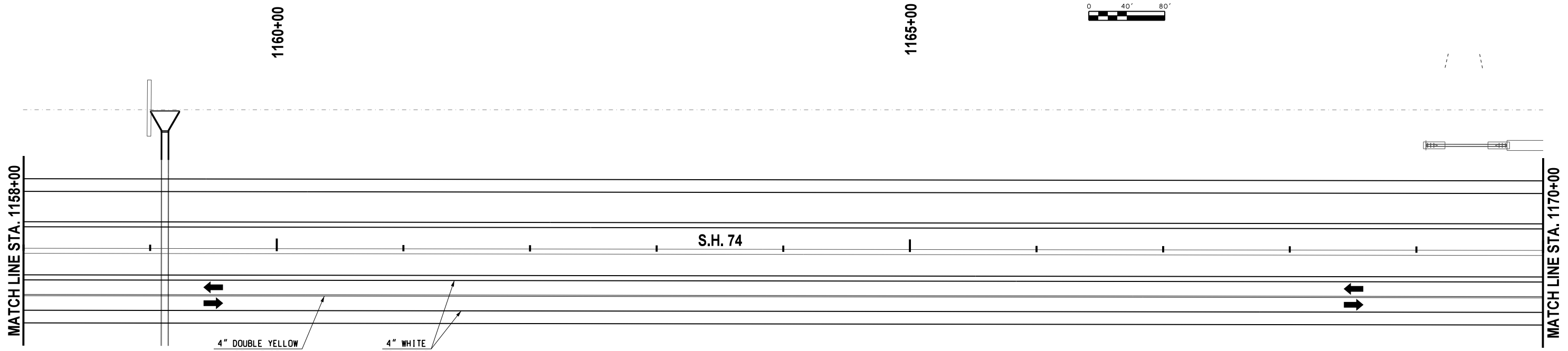

**ALL PAVEMENT MARKINGS SHALL BE REMOVABLE TAPE**

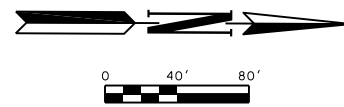
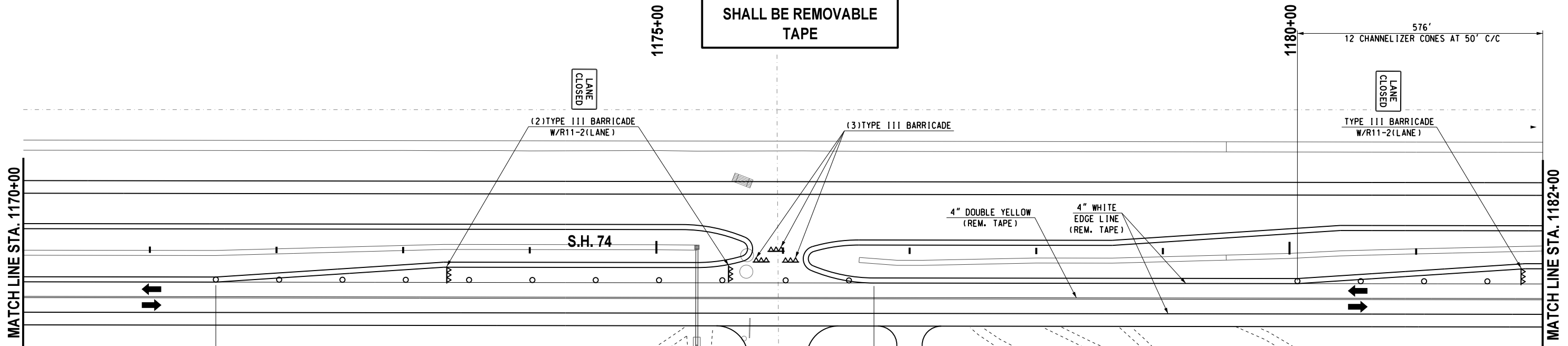

**CONTRACTOR SHALL KEEP 11' MINIMUM LANES UNLESS OTHERWISE NOTED.**

**CONTRACTOR TO PROVIDE ACCESS TO ALL DRIVEWAYS DURING CONSTRUCTION.**

**LEGEND**

- ▲▲▲ - TYPE III BARRICADE W/ TWO TYPE "A" LIGHTS
- - DRUM
- - CHANNELIZER CONE
- ▬ - PORTABLE CONC. BARRIER WALL
- ▨ - CONSTRUCTION ZONE IMPACT ATTENUATOR
- - WORK AREA

Design	RWR	08/10/17
Drawn	GDB	08/10/17

**TRAFFIC CONTROL PHASES 3U,4A & B (SHEET 7 OF 9)**  
**S.H. 74 (STA. 1158+00 TO 1182+00)**  
 State Job No. 14964(08) Sheet No. T91

08/10/17 G:\Projects\T-1662B SH 74 @ NW 178th, NW 92nd & NW 206th\CAD\TC PHASE 3U,4A,B,7 SH 74.dgn